

# Le Chateau

BY  RICS













## INTRODUCTION

Located in the upscale diplomatic district of Katampe Extension, Abuja, this private residence blends modern luxury with tropical functionality—featuring clean lines, warm materials, and a seamless indoor-outdoor flow. Its bold façade of wood slats, textured concrete, and floating balconies offers both elegance and climate-conscious design. A large green lawn stretches across the front of the home, setting a serene tone upon arrival, while a sleek swimming pool anchors the rear, perfect for leisure and entertaining. Inside, the design showcases minimalist sophistication—from the wet and dry kitchen and private dining room to the double-height living room, sculptural lighting, and lush interior courtyard. With 5 bedrooms, 3 private lounges, a gym, walk-in closets, elevator, laundry, and premium outdoor amenities, the home reflects RICS’ signature commitment to intentional minimalism and elevated living.

**Project Name:** Le Chateau by RICS

**Location:** Katampe Extension, Abuja

### 5 Bedroom Villa

#### Outstanding Features:

- 5 Bedrooms
- 2 Maids Rooms
- 3 Living Rooms
- 2 Private Lounge
- Outdoor Lounge with grill area
- Swimming Pool
- Laundry
- Elevator
- Large front lawn
- Kitchen
- Gym
- Walk-In-Closet
- Expansive Balconies
- Garden
- Well-planned landscaping from street to premises

Architects

Grey  
Boulders<sup>®</sup>



## OVERVIEW

Nestled in Katampe Extension, Abuja, this private residence designed by GreyBoulders redefines luxury living with a distinctly modern edge. The architecture harmonizes clean lines, warm materials, and expansive glass with tropical functionality, creating a seamless indoor-outdoor experience. Its bold façade—combining wood slats, textured concrete, and floating balconies—is both visually striking and deeply practical, offering shade, ventilation, and privacy.

Inside, the design continues with minimalist elegance. A sleek kitchen setup includes both wet and dry zones, blending matte grey and taupe cabinetry, underlit counters, and a sculpted island for modern family living. An adjoining private dining room offers an intimate space for entertaining. The double-height living area evokes openness and calm, with plush, low-profile furniture, artistic lighting, and lush greenery that softens the geometry. A striking interior courtyard with black lattice screening and a landscaped planter infuses biophilic beauty into the home's core, illuminated by soft, recessed lighting for a serene ambiance.

Every detail of this home reflects GreyBoulders' commitment to intentional minimalism and spatial harmony. From the curated outdoor lounge areas and poolside terraces to the integrated lighting and neutral palette, the residence balances international design sophistication with Nigeria's local lifestyle and climate. It is both a functional retreat and an architectural statement—crafted to elevate everyday living.



# PLANS



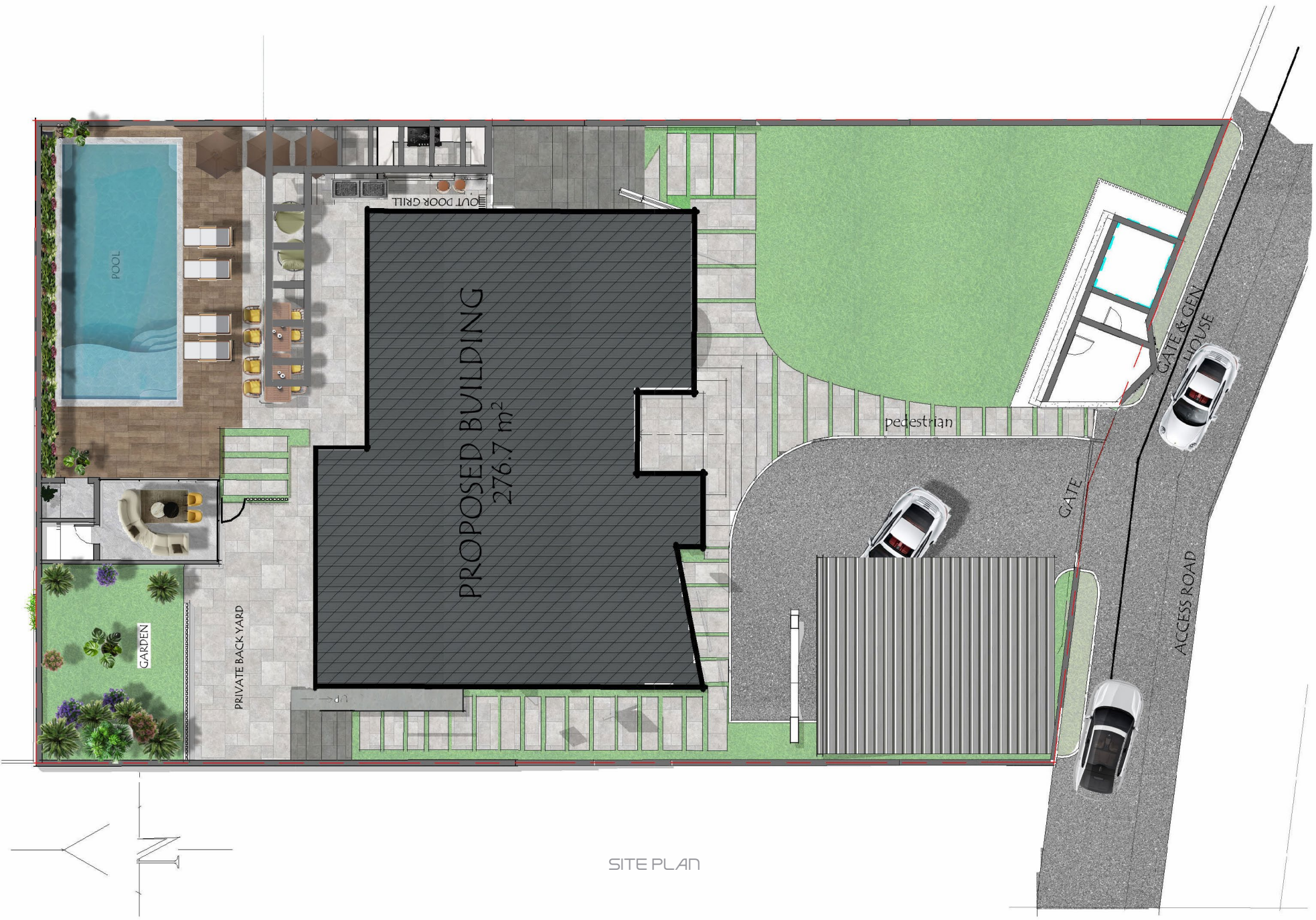

SITE PLAN





GROUND FLOOR PLAN





GROUND FLOOR PLAN





FIRST FLOOR PLAN





SECOND FLOOR PLAN



# FACADE RENDERINGS











































# INTERIOR RENDERINGS





Living Room





Living Room





Living Room













Kitchen





Architects:

Grey  
Boulders<sup>®</sup>  
+234 907 811 8741

RICS  
© 2025